

Chain Operated Roller Blind System

Silent Gliss® 4840

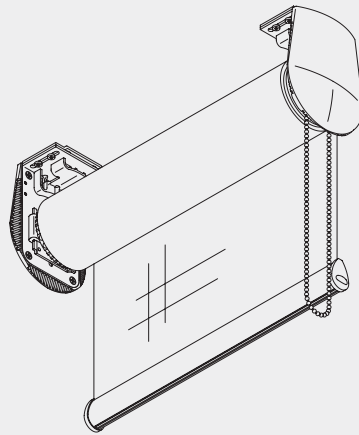

Product Information

- Very heavy duty chain operated Roller blind system (right or left hand operation).
- Ideal for contract use.
- With the Silent Gliss 4840, extremely large windows can be covered by one single chain-operated system.
- The unique planetary gear with integrated brake ensures a smooth and light operation and the blind stops instantly with no slippage.
- Patented Silent Gliss Quick Twist permits easy on-site adjustments of the headrail to eliminate rolling off caused by minor fabric problems (only available on systems up to 4m wide).
- Adjustable stainless steel bracket set: the vertical adjustment facility allows the fabric to be easily aligned with the window frame or the system with the ceiling on-site using a screwdriver only.
- Pre-fitted hook-on stainless steel plates take the weight of the blind during final positioning of the brackets. These are each laterally adjustable by up to 18mm.
- The blind is then conveniently fitted from below (especially important in a blind box situation).
- With the above refinements the fitting and fine-tuning of these substantial blinds is reduced to a minimum and perfect results are guaranteed.
- Metal bead chain.
- Automatic end stop.
- Optional side-guide wires with easy fitting and tensioning.
- Bracket covers for neater appearance outside recess.
- For systems over 4m wide a 110mm diameter tube is used to minimise bowing (profile 4957).



4840

Profile and Specification Information

Profile 4901 (80mm tube diameter)

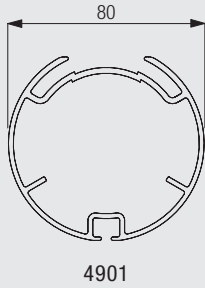

Profile 4957 (110mm tube diameter)

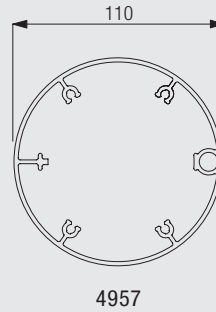

Specification Guide - download from www.silentgliss.co.uk (password required).

Silent Gliss 4840 chain operated roller blind system for very heavy duty applications. Assembled complete with anodised aluminium headrail. Smooth light operation thanks to the planetary gear and no slippage due to the integrated brake. Incorporates Silent Gliss patented Quick Twist for easy on-site adjustment of the headrail to prevent fabric roll off. Fix to wall/ceiling/inside recess with stainless steel bracket combination set 4944 incorporating hook on plates to take weight of blind during installation. Optional bracket covers. Fabrics to be selected from Silent Gliss range.

How to Measure

Measurement information with profile 4901 (80mm tube)

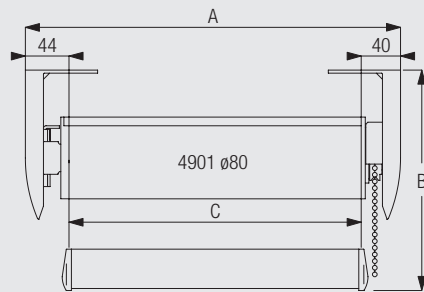

A: system width
B: system drop
C: fabric width

Attention: when installing the blind without bracket covers left and right the total system width will be reduced by 30mm (2 x 15mm)

System measures are indicated with bracket covers. Please refer to Max. Surface Area Chart for exact total maximum measures of system.

Measurement information with profile 4957 (110 mm tube)

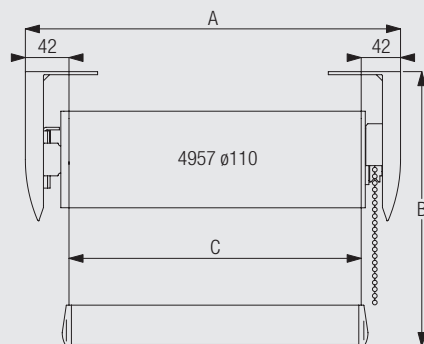

A: system width
B: system drop
C: fabric width

Attention: when installing the blind without bracket covers left and right the total system width will be reduced by 30mm (2 x 15mm)

System measures are indicated with bracket covers. Please refer to Max. Surface Area Chart for exact total maximum measures of system.

System Dimensions



4m with 4901 tube
5m with 4957 tube



50cm



6m with 4901 tube
3.75m with 4957 tube



15sqm



12.5kg with 4901 tube
9.5kg with 4957 tube

Maximum surface area chart

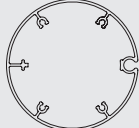
		A →							
		2 m	2.5 m	3 m	3.5 m	4 m	4.5 m	5 m	
B ↓	2 m	●	●	●	●	○	○	○	 ● 4901 (ø 80 mm)
	2.5 m	●	●	●	●	○	○	○	
	3 m	●	●	●	●	○	○	○	 ○ 4957 (ø 110 mm)
	3.5 m	●	●	●	●	○			
	4 m	●	●	●	●				
	4.5 m	●	●	●					
	5 m	●	●	●					
	5.5 m	●	●		max. 15 m ²				
6 m	●	●							

(A: Width / B: Height) The maximum surface always depends on available fabric widths and fabric weight. Any system 4m or above in width will be supplied with the profile 4957 (110 mm tube).

System Options

Side guides

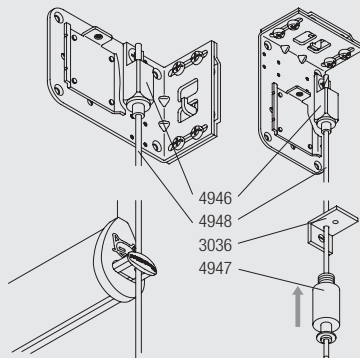

- 4946 Top fastener
- 4948 Wire rope (1.5mm)
- 3036 Bracket
- 4947 Bottom fastener

The bracket 3134 (with cover 3133) can be used as an alternative to 3036 for greater clearance.



4840

Fitting Information

Bracket positioning and basic fitting features

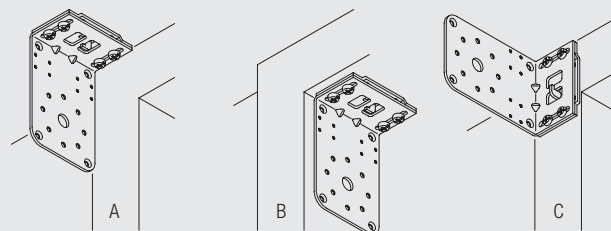

A: Ceiling fix
B: Recess fix
C: Wall fix

Silent Gliss Quick Twist (patented)

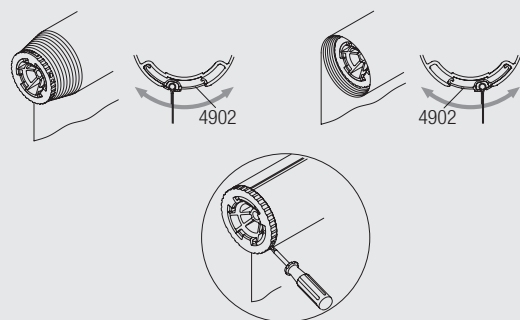

Adjustment feature for minimising fabric roll off.

Patented Silent Gliss Quick Twist permits easy on-site adjustments of the headrail to minimise fabric roll off (only available on systems up to 4m width, using the 80mm tube 4901).

Hook-in installation plates



4840

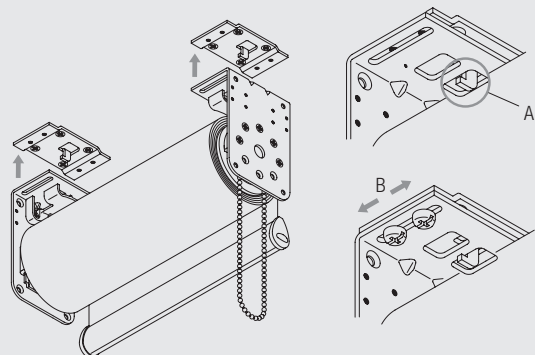

The brackets can be laterally adjusted by up to 18mm.

Specially designed pre-fitted hook-in plates (A) take the weight of the blind during final positioning of the brackets (B).

Adjustable stainless steel bracket set (for vertical adjustments)

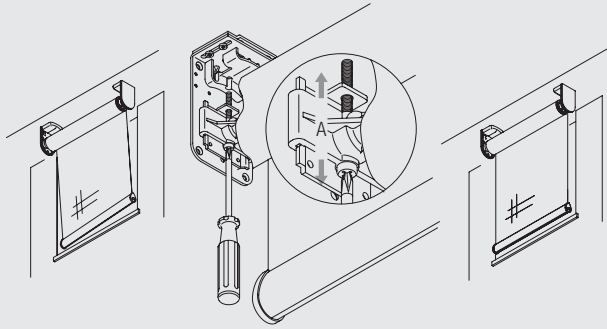

Vertical adjustment of the system (A) allows the head tube to be levelled.

Fitting Options

CAD download from www.silentgliss.co.uk (password required).

Ceiling fix (profile 4901; 80mm tube)

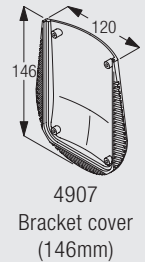
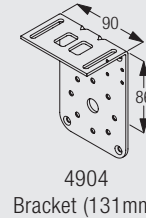
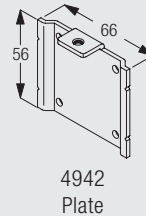
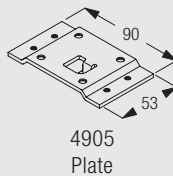
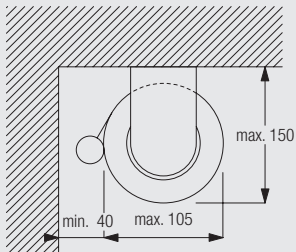

Please note: The above key fitting parts are part of bracket set 4949.

Ceiling fix (profile 4957; 110mm tube)

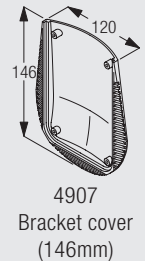
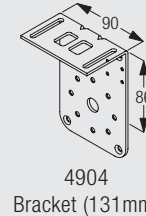
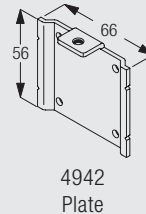
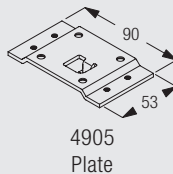
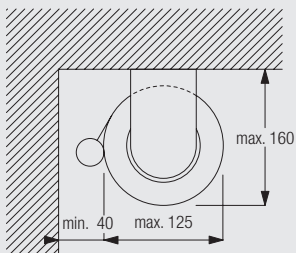

Please note: the above key fitting parts are part of bracket set 4949.



4840

Recess fix (profile 4901; 80mm tube)

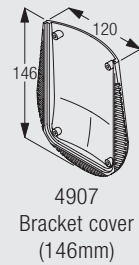
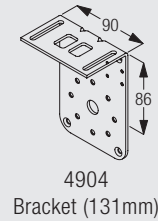
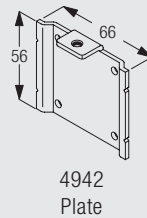
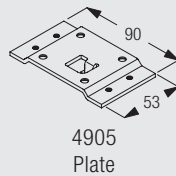
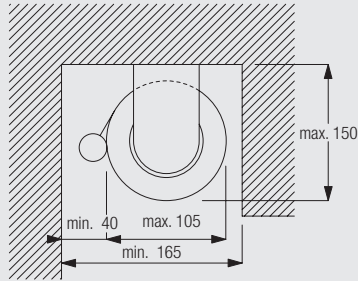

Please note: the above key fitting parts are part of bracket set 4949.

Recess fix (profile 4957; 110mm tube)

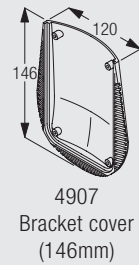
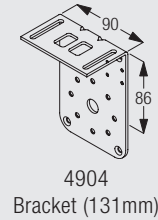
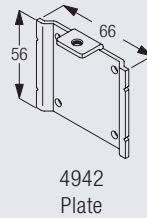
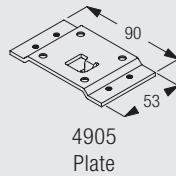
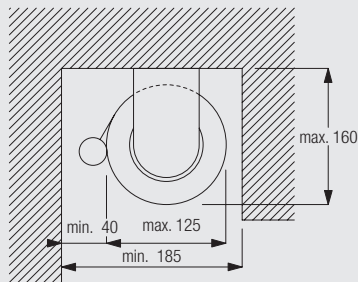

Please note: the above key fitting parts are part of bracket set 4949.

Wall fix (profile 4901; 80mm tube)



4840

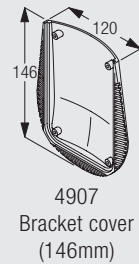
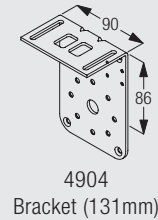
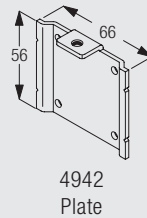
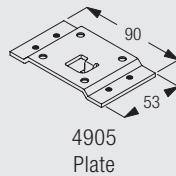
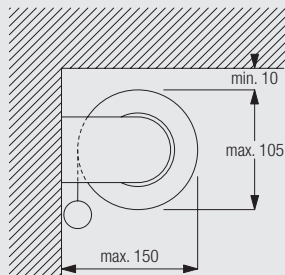





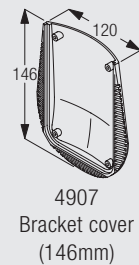
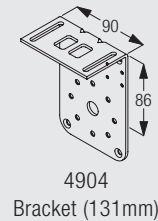
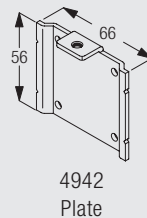
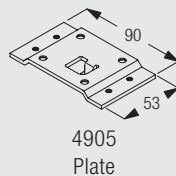
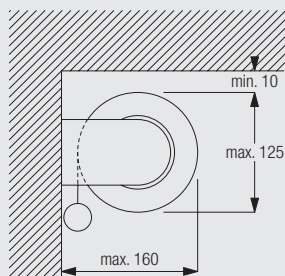

Please note: the above key fitting parts are part of bracket set 4949.

Wall fix (profile 4957; 110mm tube)



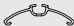

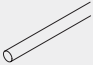
Please note: the above key fitting parts are part of bracket set 4949.

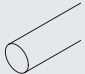

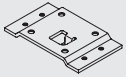
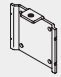

Standard Accessories

0998	Safety Cord Retainer		4901	Profile	
4902	Profile		4903	Bottom bar	
4907	Bracket cover (146mm)		4943	Acrylic rod (ø4mm)	
4957	Profile		4963	Acrylic rod (ø6mm)	

Sets

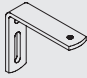
4949	Bracket set, containing		4904	Bracket (131mm)	2	
			4905	Plate	2	
			4942	Plate	1	
			4966	Special screw	1	

Optional Accessories

3036	Bracket (47mm)		3133	Bracket cover (60mm)		
3134	Extension bracket (60mm)		3799	Cord Tidy		
4946	Wire rope top fastener		4947	Wire rope bottom fastener		
4948	Wire rope (ø 1,5mm)					



4840